

WMHS Public Forum  
November 10, 2021



ENVISIONING  
THE NEW  
WAKEFIELD  
MEMORIAL  
HIGH SCHOOL  
FACILITY



SMMA





# Agenda



1. WMHS Visioning Process Overview
2. Highlights from Workshops One and Two
3. Interactive Priority Setting *Activity*
4. Upcoming Workshops



# The Visioning Process

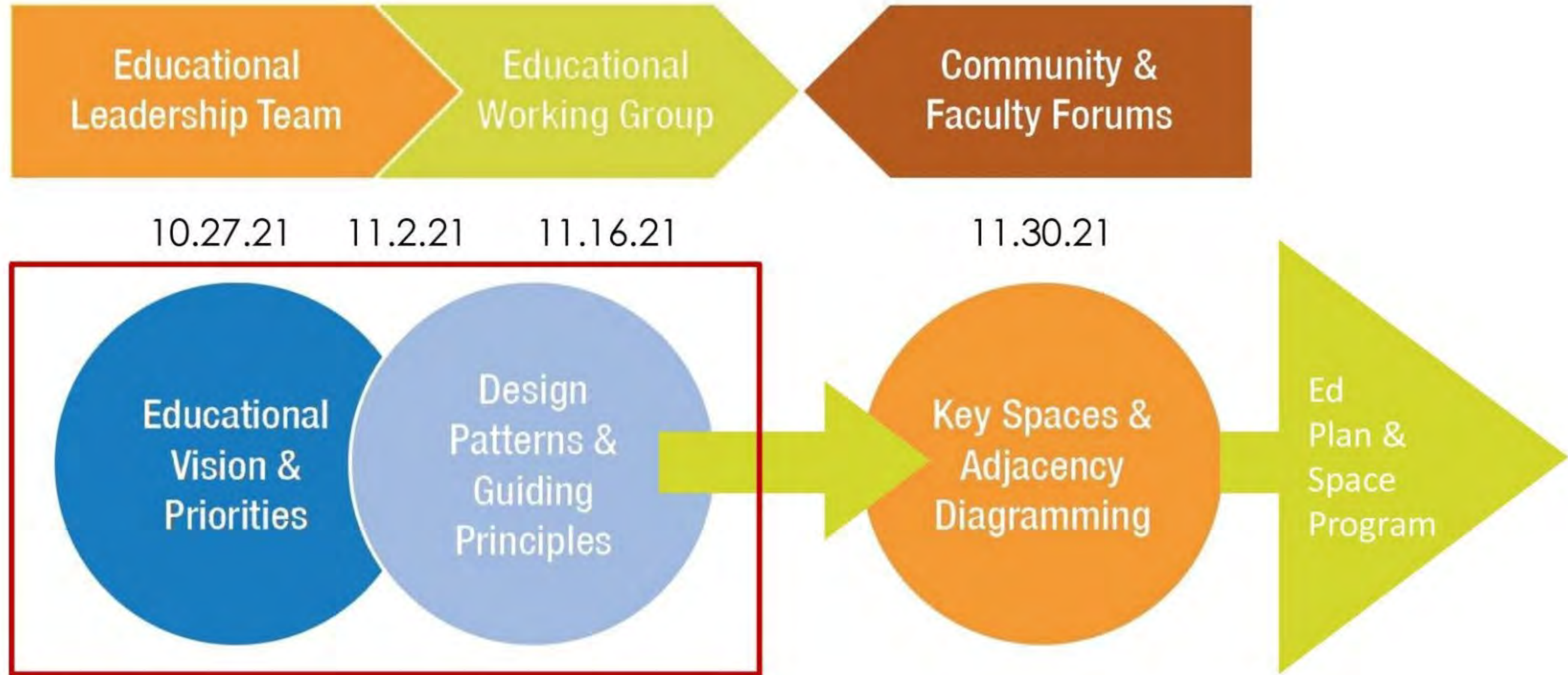



# The Visioning Team

## 33 Participants

- Teachers
- Administrators
- Parents
- Community Partners
- Community Members





# Virtual Visioning

- Shorter Workshops
- Highly Interactive
- Breakout Groups Discussions
- Chat Function Feedback
- Google Docs Info Collection
- Interactive Software for Real-Time feedback

Go to [www.menti.com](http://www.menti.com) and use the code 8917 9126

Please share your Greatest Hope for the WMHS program and facility:

Thinks people consider learning disabilities a physical space and technology available to teachers and students.	...well to come every day - a place that is warm, comforting, and brings them hope and inspiration to learn and grow.	Learning for all teachers is what is need to teach.
Larger learning spaces to promote collaborative learning. A warm and inviting facility that people want to go to and that the community can be proud of.	Natural spaces, native plants, perennial and vegetable gardens, green roofs, mindfulness gardens and paths, ecological spaces that complement the five station around us.	A school that can bring fun and joy to students, teachers and other.
		A space where teacher interdisciplinary collaboration is a priority and a possibility.





# Developing a Narrative

- Educational vision
- Design priorities and goals
- Desired adjacencies
- Optimization of MSBA space template
- Educational Plan





# Workshop Notes

<https://wakefieldmhsproject.com/design-phase/>



## Design Phase

### Feasibility Study

#### Educational Visioning

- 📄 Educational Visioning Overview and Access
- 📄 Educational Visioning K-12 Glossary of Terms
- 📄 Educational Visioning Workshop One - Handouts
- 📄 Educational Visioning Workshop One - Notes
- 📄 Educational Visioning Workshop One - Recording







# Any renovated or New MSBA School Will Have...

- ADA Compliance
- Safe Entry and Security Features
- Thermal Comfort (Heating and Cooling)
- Sustainable Building Features
- Modern Technology and Furniture
- Well-Sized Classrooms with Natural Light





# Big Picture Themes

- Flexible and Adaptable
- Fully Wired and Fully Usable
- Small and Large Scale Community
- Learning Beyond the Classroom
- Varied and Connected Spaces
- Practical not Trendy





# This is an Opportunity to...



Massachusetts School Building Authority  
*Funding Affordable, Sustainable, and Efficient Schools in Partnership with Local Communities*

- Reflect on your District and School Agenda and Needs
- Push your thinking about what is possible
- Envision a building that will last you for decades to come
- Be practical and forward thinking...

*Be aspirational in your thinking,  
Compromises will need to be made*





# Priorities

Educational, Architectural and Community



# Educational Priorities

- Support for Emerging Practices
- Collaborative and Interdisciplinary Learning
- Student Engagement and Inspiration
- Inclusive School Culture
- Special Education Resources and Services
- Integrated Use of Technology





# Please share your top EDUCATIONAL PRIORITIES for the WMHS program.

Collaboration

Flexible classroom spaces to be adaptable over time for new educational needs

Universal design

Classes that prepare students for colleges as well as for life.

Equity

open spaces for group work/activities

Spaces for student agency

Outdoor learning spaces

Transparency



# Please share your top EDUCATIONAL PRIORITIES for the WMHS program.

community access to recreational spaces during off time





# Architectural Priorities

- Innovative and Inspiring Building
- Safety and Welcome
- Evolving, and Flexible Building
- Visible Learning and Display
- Equal Access and Opportunities
- Support for Inquiry Based Learning and STEAM





# Please share your top ARCHITECTURAL PRIORITIES for the WMHS facility.

Daylighting

Potential for separation of community spaces and school

Easy navigation



# Community Priorities

- A Good Fit for the Community
- Community Use and Access
- Access to Fields and Outdoor Spaces
- Art, Music, and Performance Space
- Parking and Site Circulation





# Please share your top **COMMUNITY PRIORITIES** for the WMHS program and facility.

Net zero emissions (no gas heat)

Shared community spaces - Theater, Field House, Maker spaces

Access to recreational spaces during non-school time

Multi modal transportation plan







Future Ready

Teaching and Learning



# 21<sup>st</sup> Century Skills

What does Future Ready Teaching and Learning mean to your school?

## THE 6 R'S

READING RIGOR  
WRITING RELEVANCE  
ARITHMETIC RELATIONSHIP

## THE 4 C'S

CRITICAL THINKING  
COMMUNICATION  
COLLABORATION  
CREATIVITY  
+ *Citizenship*

**Head & Hand**

**SEL: Social Emotional**

- Student-Centered
- Interdisciplinary
- Technology-Infused
- Fully Inclusive/Differentiated
- Universal Design for Learning
- Community Connected
- Problem and Project-Based
- STEM and STEAM
- Process and Product Oriented





# Social Emotional Learning



- Character education
- Growth Mindset
- Mental health
- Mindfulness
- Resilience and Grit
- Classroom management





# Skills for a New Economy

## in 2020

1. Complex Problem Solving
2. Critical Thinking
3. Creativity
4. People Management
5. Coordinating with Others
6. Emotional Intelligence
7. Judgment and Decision Making
8. Service Orientation
9. Negotiation
10. Cognitive Flexibility







Source: Future of Jobs Report, World Economic Forum

## Top 10 skills of 2025

-  Analytical thinking and innovation
-  Active learning and learning strategies
-  Complex problem-solving
-  Critical thinking and analysis
-  Creativity, originality and initiative
-  Leadership and social influence
-  Technology use, monitoring and control
-  Technology design and programming
-  Resilience, stress tolerance and flexibility
-  Reasoning, problem-solving and ideation

### Type of skill

-  Problem-solving
-  Self-management
-  Working with people
-  Technology use and development

Source: Future of Jobs Report 2020, World Economic Forum.





# 21<sup>st</sup> Century Skills

- Social Emotional Learning
- College and Career Pathways
- Real World Connections
- Differentiated Instruction
- Student-Centered Learning
- Universal Design for Learning
- STEM and STEAM
- Project-Based Learning
- Master of Core Academics
- Visual and Performing Arts
- Growth Mindset
- Individualized Learning
- Deeper Learning
- Service Learning and Internships
- Professional Learning Communities

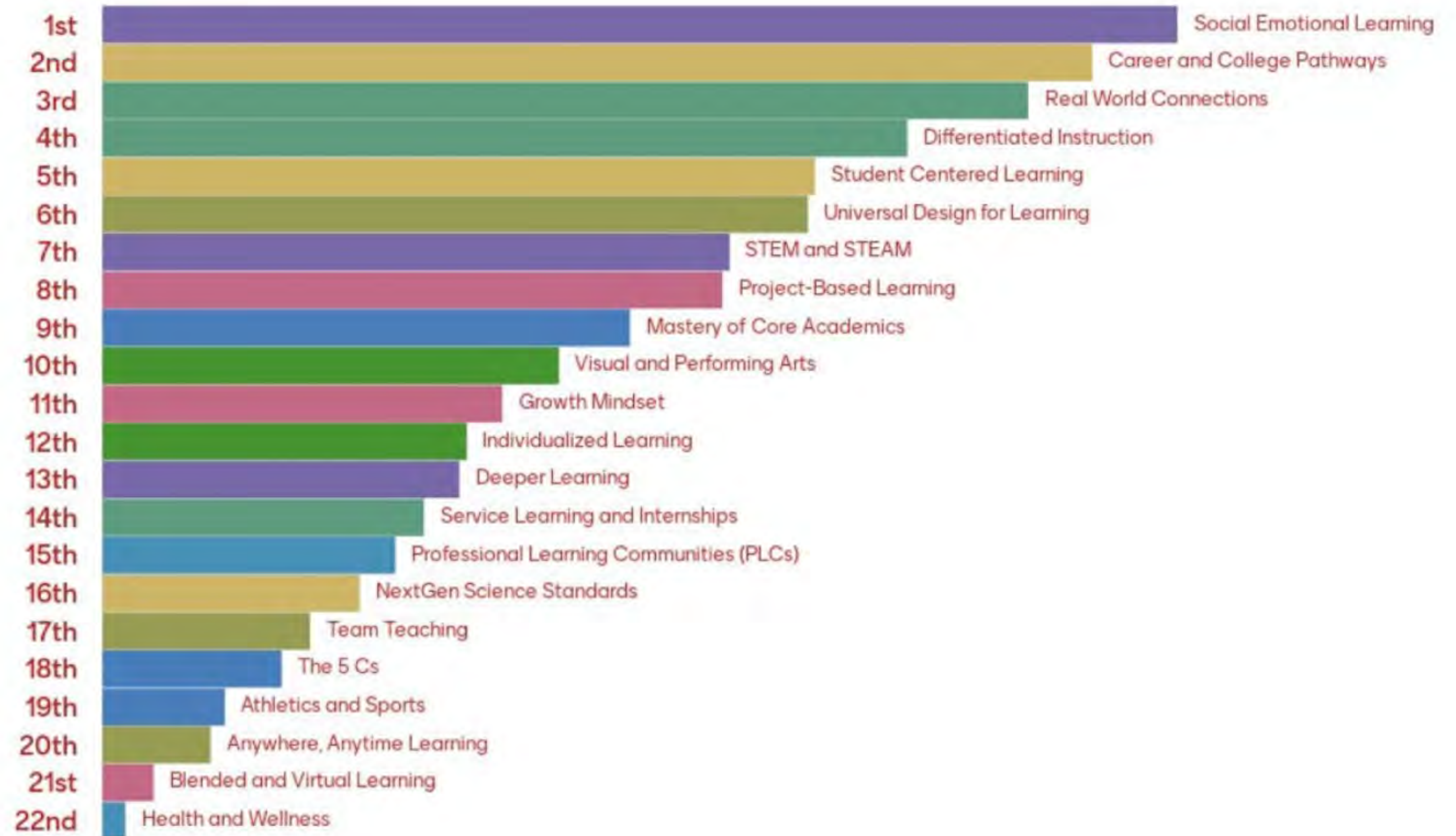



# 21<sup>st</sup> Century Skills at WMHS

- Social Emotional Learning
- College and Career Pathways
- Real World Connections
- Differentiated Instruction
- Student-Centered Learning
- Universal Design for Learning

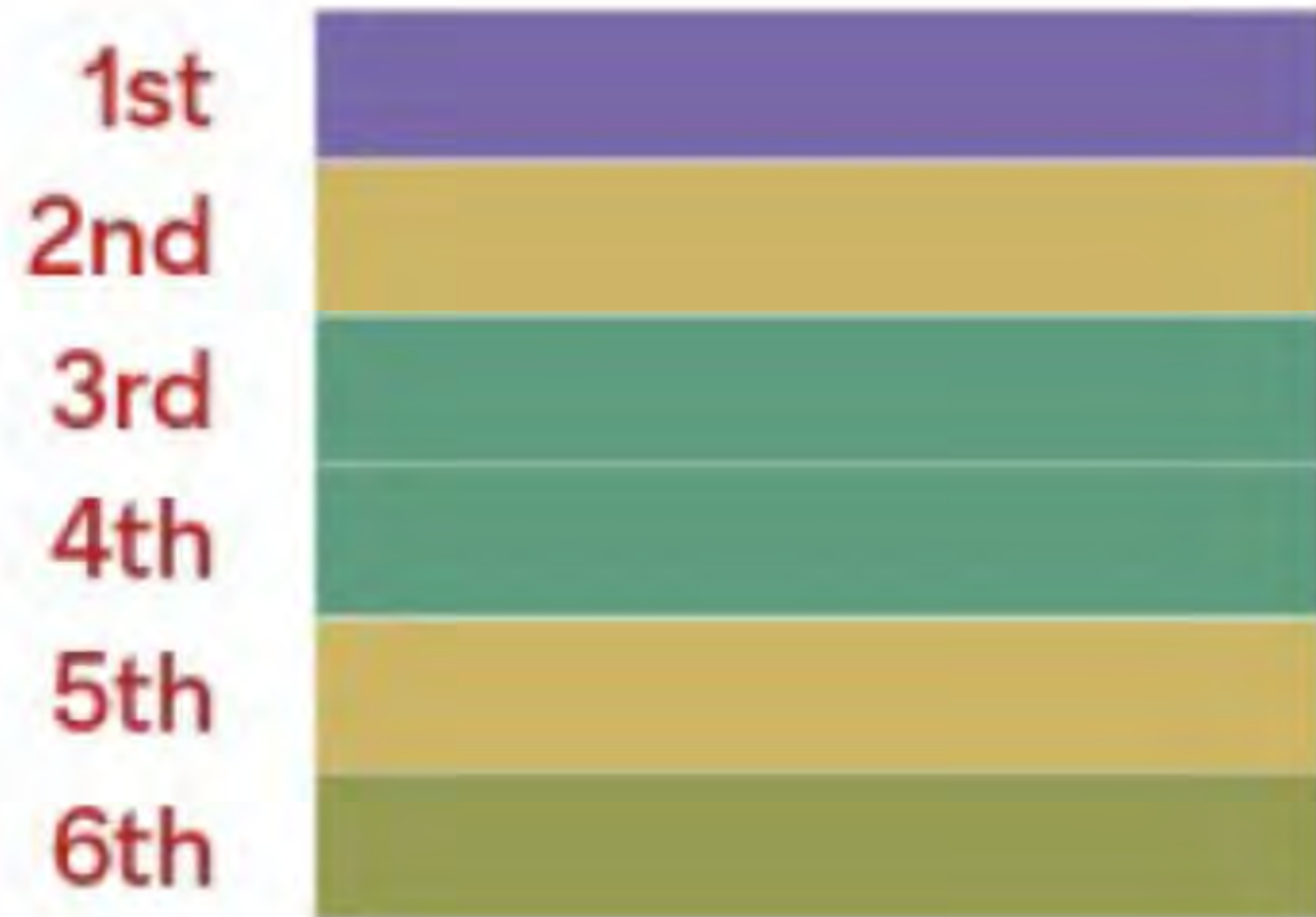



# Future Ready Learning Goals 2.0

## Future Ready Warriors: Propelling Learning Forward

- **Global Citizenship**
  - Honesty, Integrity and Caring, Empathy
  - Intercultural Awareness and Competence
  - Empathy, Humility, and Joy
  - Diversity, Equity, and Inclusion
  - Engaged Citizenship
  - Civic-Minded Service
  - Sense of Belonging
- **Inventive Thinking and Problem Solving**
  - Imagination, Creativity, and Curiosity
  - Critical Thinking
  - Hands-On, Experiential Learning
  - Application of Learning to Real World Processes
  - Discovery of New Skills and Interests
  - Focus on Careers of the Future
- **Self-Directed Learning**
  - Growth Mindset
  - Lifelong Learning
  - Intrinsic Motivation
  - College and/or Career Readiness
  - Developing Self Confidence and Advocacy
  - Commitment
- **Social Emotional Intelligence**
  - Managing Responsibility
  - Interpersonal Skills
  - Mental Health and Wellness
  - Adaptability and Managing Complexity
  - Engagement with Others
  - Metacognition and Reflection
  - Social Life Skills
- **Effective Communication**
  - Verbal, Non-Verbal, and Social
- **Digital Age Literacy**
  - Information Literacy
  - Technological Proficiency
- **Collaboration and Leadership**
  - Students and Teachers
- **Mastery of Core Academics**
  - College and Career Ready
  - Test Prep



# What are your top 6 Future Ready Learning Goals for WMHS students?

mastery of core academic

leadership

creative thinking

empathy

global perspective

problem solving

adaptability

growth mindset

digital literacy

self directed learning





# Program Overview



## Main office/welcome

Students, families, and visitors are greeted and welcomed to the WMHS community through the main office space. This should be a welcoming area with space for students and visitors to wait for meetings, dismissal pickups, etc.

## Key Program Features

- Open and welcoming space for students, families, and other visitors
- Organized so that students can check in and access needed supports
- Set up to provide working space for 3 administrative assistants and 3 administrators
- Private spaces for students to wait, especially in disciplinary cases

*Educational Visioning WS Two 11.2.21*

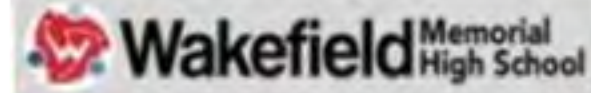

## Key Space Needs

- A reception area where Administrative Assistants can welcome students and families
- Ample office space for Administrators to meet with teachers or small groups (students and families)
- School Resources Officer office
- Area for copying, scanning, and clerical tasks
- Space for fridge, microwave, and water cooler
- Bathroom

## Looking Forward

Flexible meeting space for collaboration, family meetings, student/administrative meetings, etc.

## Core Academics

Students enroll in a variety of rich courses in the core academic areas: English Language Arts, Mathematics, Science, Social Studies, and World Languages.

## Key Program Features

- All core academic courses prepare students for post-secondary academic courses of study and employment.
- Courses are offered in all core subjects at college-preparatory, honors, and Advanced Placement levels.
- Courses are offered to all students with a variety of inclusive practices (differentiation, Universal Design for Learning, special education support, etc.) to make sure all students are being met where they are and given the opportunity to develop their academic skills in a rigorous learning environment.

*Educational Visioning WS Two 11.2.21*

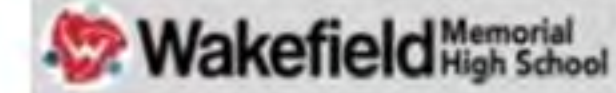

## Key Space Needs

- Students and educators need a variety of comfortable, flexible, and collaborative spaces that promote future-ready teaching and learning.
- Space to infuse new technology as well as a place for students to showcase their work.
- Outdoor classroom spaces as an extension of the learning environment.
- Science laboratory space to support inquiry-based learning

## Looking Forward

- Spaces that provide opportunities for students to think creatively, collaboratively, and critically while engaging in inquiry based activities that will promote the development of skills necessary to be contributing members of their local, national, and global communities.

## Student Support/Guidance

The Student Support/Guidance department consists of guidance counselors, adjustment counselors, school psychologists, and school nurses.

## Key Program Features

- Guidance counselors work with students to help develop their academic, career, and social/emotional skills (including individual and group counseling).
- Two adjustment counselors and two school psychologists provide individual and group counseling to students who need Tier 2 or 3 support (higher level). They also play a critical role in providing support in crisis situations.
- School nurses attend to all health related issues that occur within the school day, including health related crises.
- All guidance and support staff communicate and collaborate with families, teachers, and each other to provide the best support possible to our students.

*Educational Visioning WS Two 11.2.21*

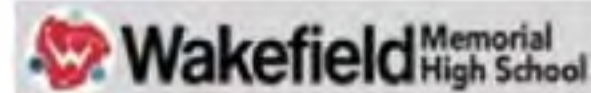

Insert photo or graphic here if you like....

## Key Space Needs

- Individual offices with privacy and small table for meetings
- Lobby area that includes space for administrative assistant, 3-4 round tables, 2-3 individual desks, copier, and shelving for materials
- Small conference room designated solely for Student Support meetings
- A separate space for a "College & Career Center"
- Closet area for files and supplies
- Small area for fridge, microwave, water cooler

## Looking Forward

- We envision a warm, welcoming, and accepting environment that is designed to meet the academic, career, and social emotional needs of our students.
- A place that feels safe to talk confidentially
- A place that serves as a hub for internships, college and career exploration, and self-discovery

## Visual Arts/TV Media

The Visual Arts / TV Media Department is an inclusive program that successfully prepares students for college and careers, as well as provides an avenue for all students, regardless of talent, to express their individuality and creativity.

## Key Program Features

- We offer multiple disciplines within the Visual Arts
  - Studio Art 1&2
  - Ceramics 1&2
  - Graphic Design
  - Honors Illustration / Drawing & Painting
  - Digital & Darkroom Photography
  - AP Art
  - TV Production 1,2,3 & 4
  - Multimedia
  - Film Studies
- With most classes including 9-12 graders, young students have the unique opportunity to interact with students older than them in an academic setting.
- Many students continue on in college as Visual Art or TV/Media majors.

*Educational Visioning WS Two 11.2.21*

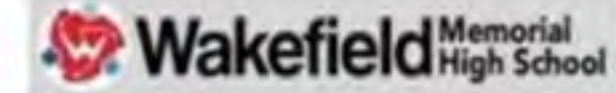

## Key Space Needs

- 3-D workspaces
- 2-D workspaces
- Digital workspaces
- Photography Studios
- Proper Lighting for photographing 2D & 3D work
- Multiple Sinks and Clay traps for sinks
- Ample storage for supplies and student work
- Ample electrical outlets for all work spaces
- Sound / Editing Room
- Green Screen / Sound Stage
- TV Studio with proper Lighting and High ceilings
- Locked storage for equipment

## Looking Forward

I look forward to our future vision of WMHS Visual Arts / Media Department to have ample space for individual and collaborative work. These spaces need to be flexible in order to be used by a variety of disciplines and media within the department. Display or small gallery in the community space as well as ours.





# Top 10 Design Patterns



# Rate Every Slide



LOVE IT!



GREAT IDEA



NOT SO MUCH



MAYBE



# New School Design Patterns

# Universal Design and Access





# New School Design Patterns

## Agile Classrooms





# New School Design Patterns

# Extended Learning Spaces



Da Vinci Wiseburn HS – Gensler with New Vista



Sanford Regional Technical Center – Lavalée Brensinger with New Vista





# New School Design Patterns

# Breakout and Quiet Spaces



The Roper School – HMFH

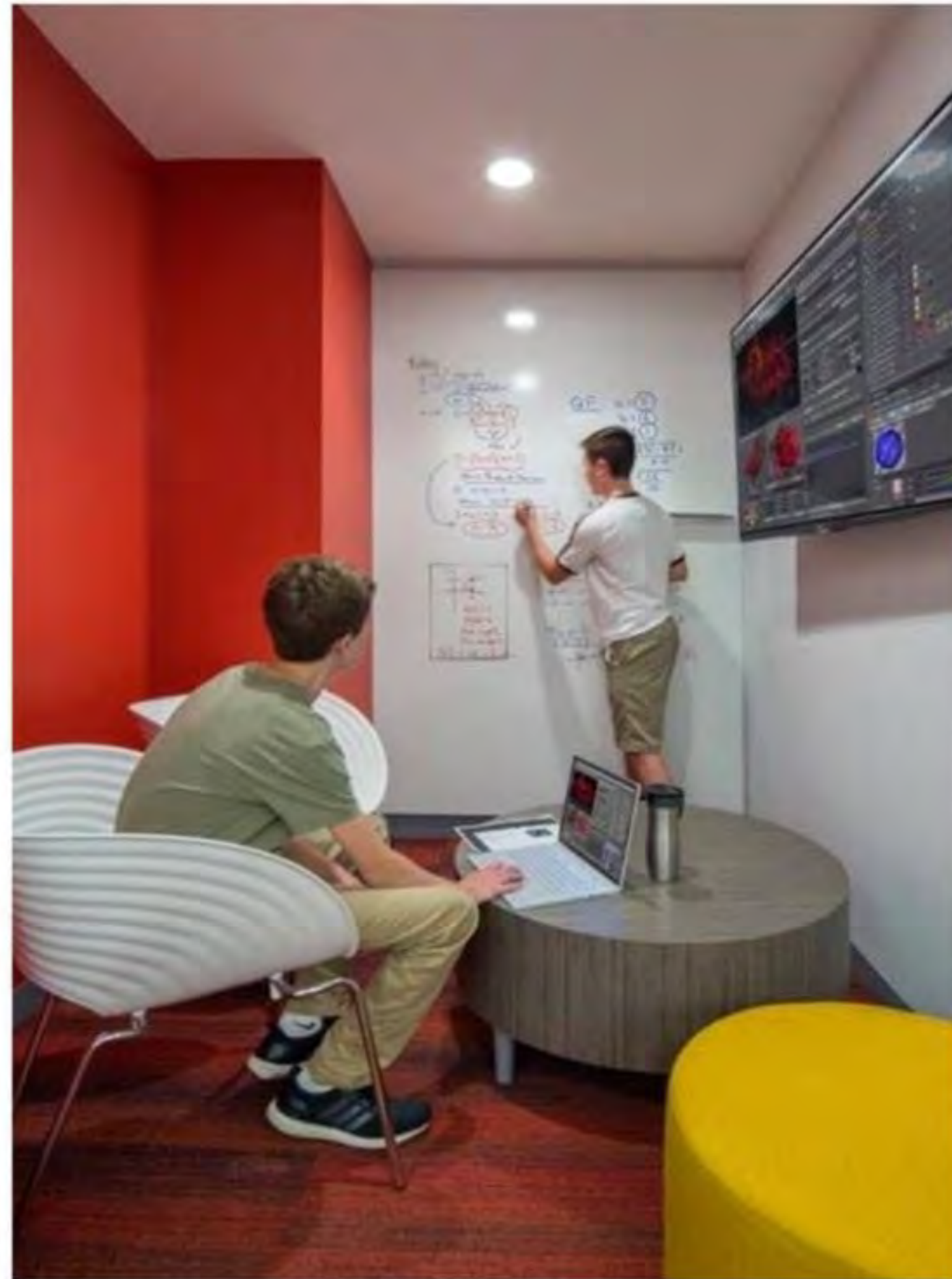

Beverly Middle School – Ai3





# New School Design Patterns

# STEM/STEAM & Makerspaces





# New School Design Patterns

# Classroom Neighborhoods

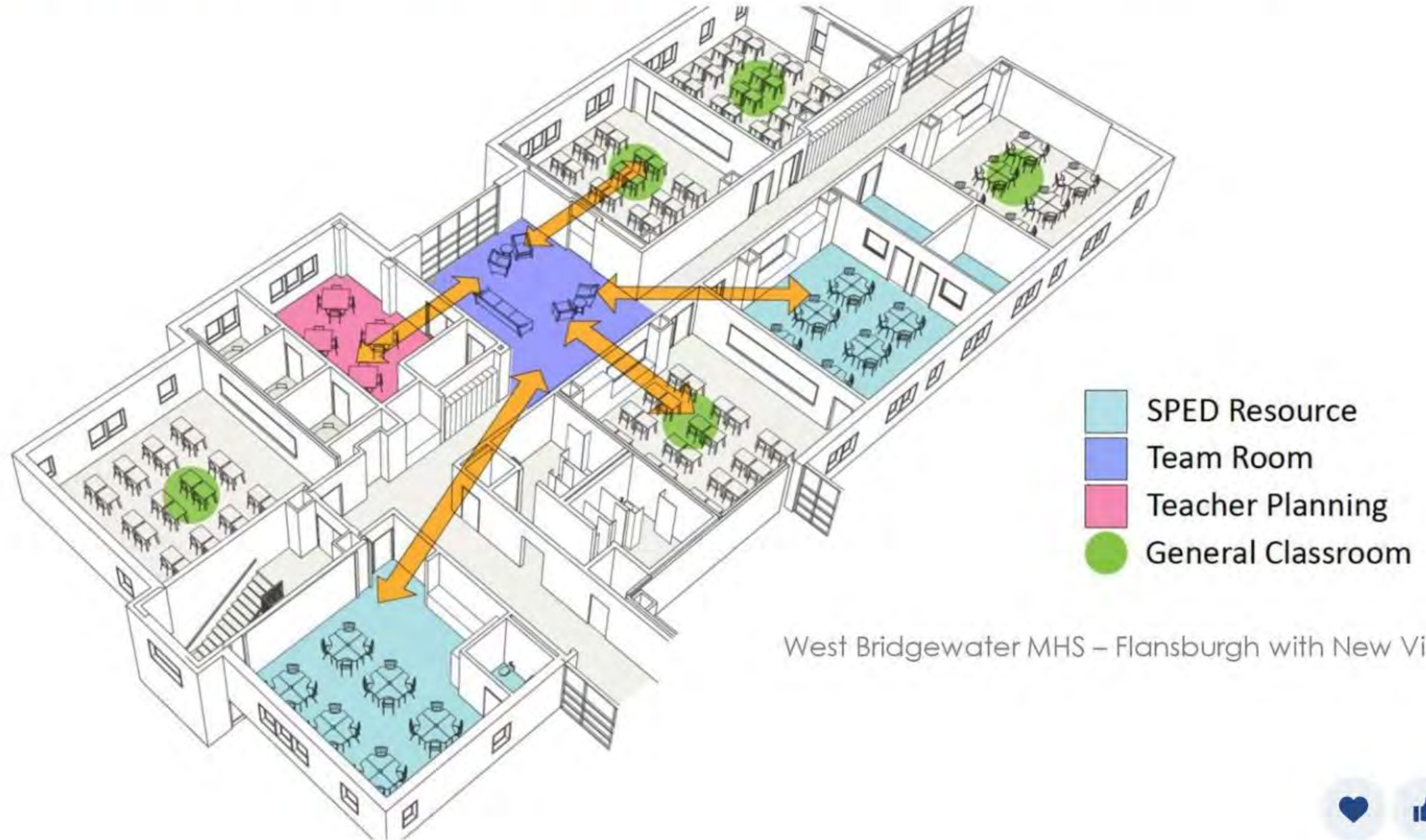

West Bridgewater MHS – Flansburgh with New Vista



# New School Design Patterns

# Welcoming Arrival



Essex Tech – Perkins Eastman with New Vista



Roosevelt high School – Perkins Eastman





# New School Design Patterns

## Security and Welcome

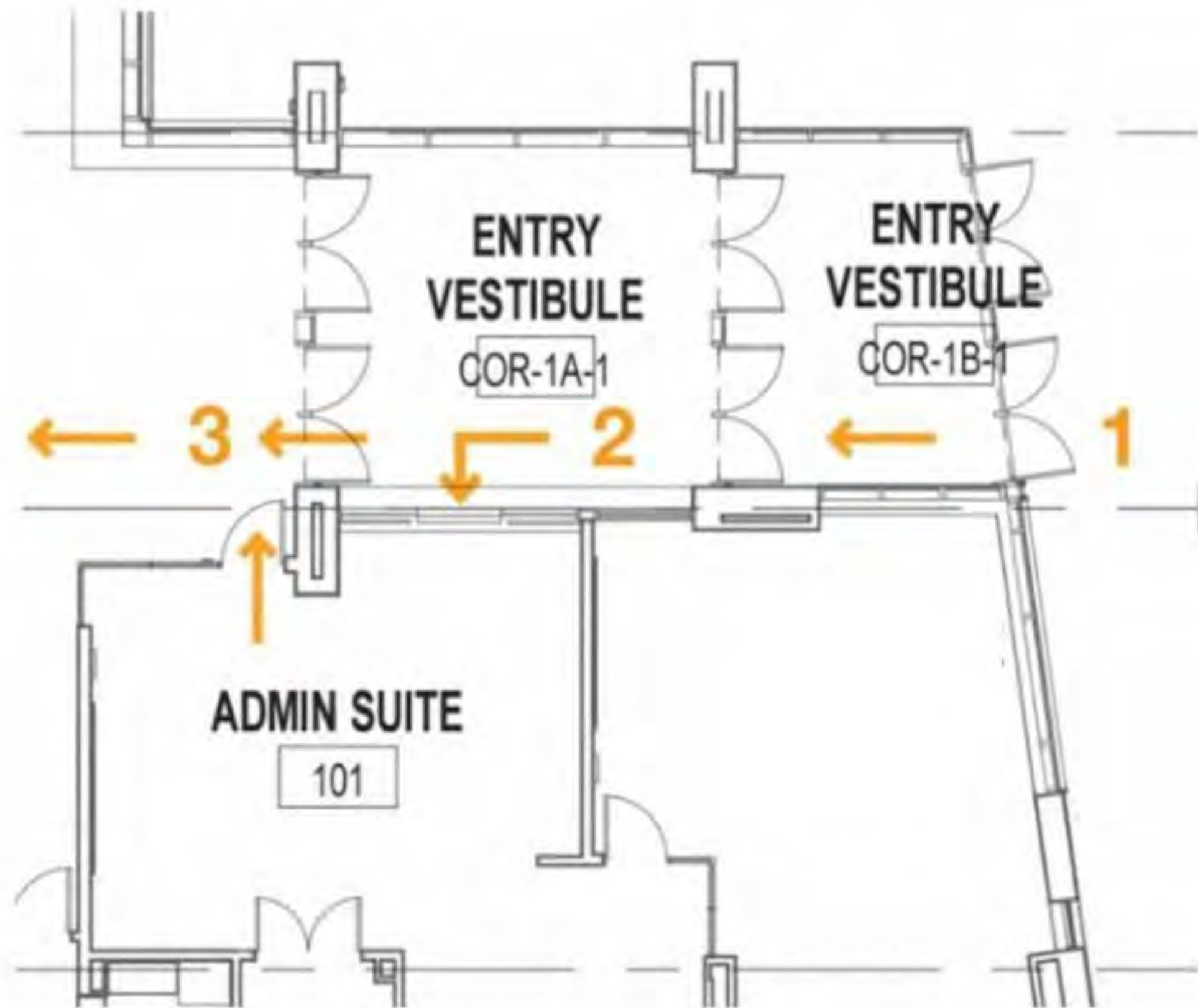

### GLOBAL PRINCIPLES

TOP STRATEGIES FROM GLOBAL CONVERSATION

- **Visibility / Transparency / connectedness – strategic approach**
- **Single point of entry**
- **Welcoming / not prison feel**
- **Process of design / align with policy / align with first responders**
- **Pride of ownership / define public and private**
- **Social / emotional connectedness**
- **Layers of access control / visibility – cameras/ authorized access**
- **Feeling of safety**
- **Diversity of learning spaces**
- **Integrated communication plan**
- **Education around safety and security policy / features**
- **Place within the classroom that provides a sense of safety**
- **Design safety through architecture**



# New School Design Patterns

## Community Access



West Bridgewater MHS2 - Flansburgh with New Vista



# New School Design Patterns

## Heart of the School







# Upcoming Workshops

11.16.21 and 11.30.21



**Guiding Principles** set design priorities and offer an invaluable framework for making decisions and choices as the design process unfolds...



# WEST BRIDGEWATER MIDDLE HIGH SCHOOL



1. School as Community Resource
2. STEM/Art Integration (STEAM)
3. Personalization, Connection and Ownership
4. Adaptability and Evolution
5. Visible Learning
6. Outdoor Connections



# Blue Sky Ideas ... *Detailed*

Take 15 minutes to describe and/or diagram one of your ideas in as much detail as possible

- Size
- Shape
- Use
- Furniture
- Lighting
- Color
- Occupants
- Etc.

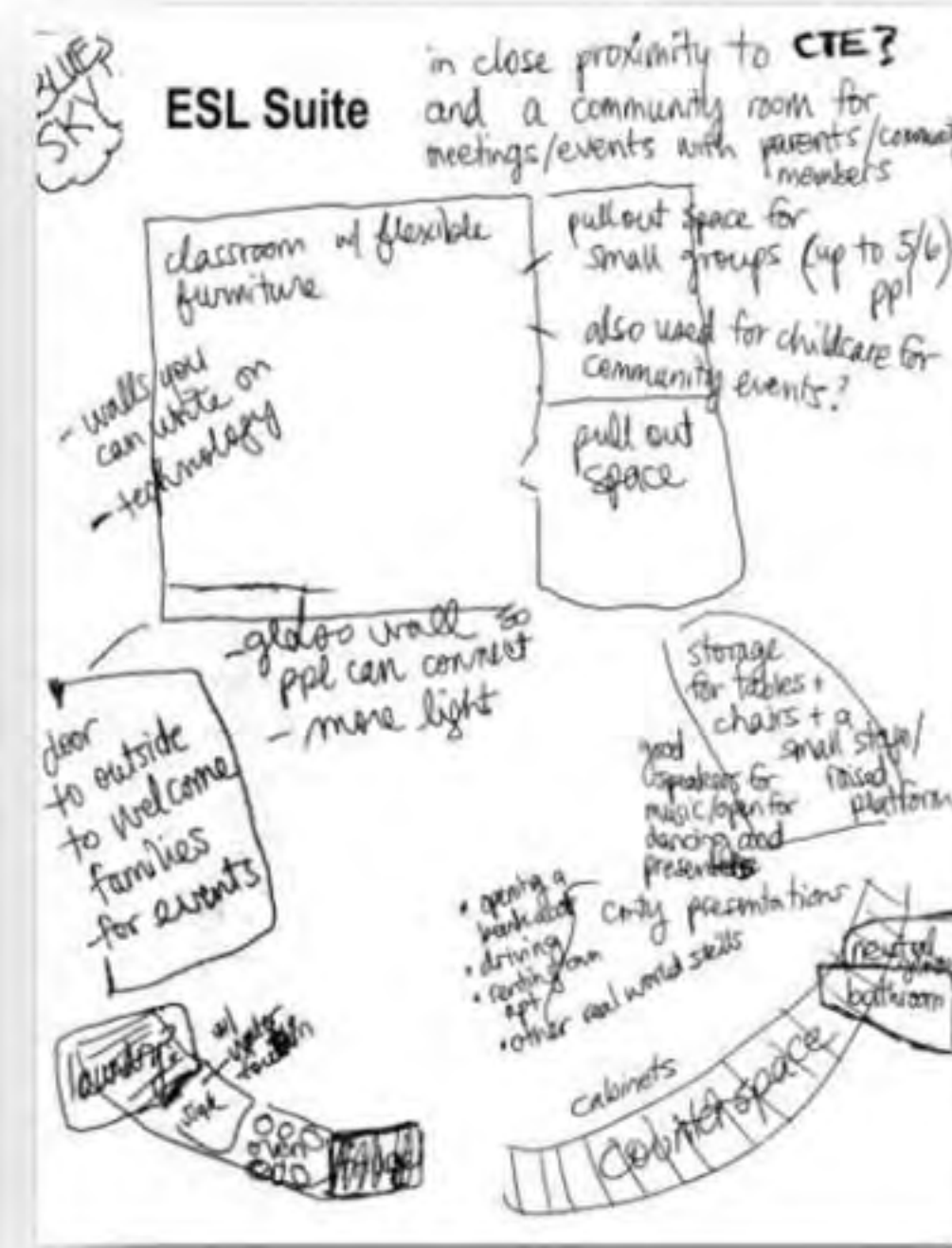



# Bubble Diagrams

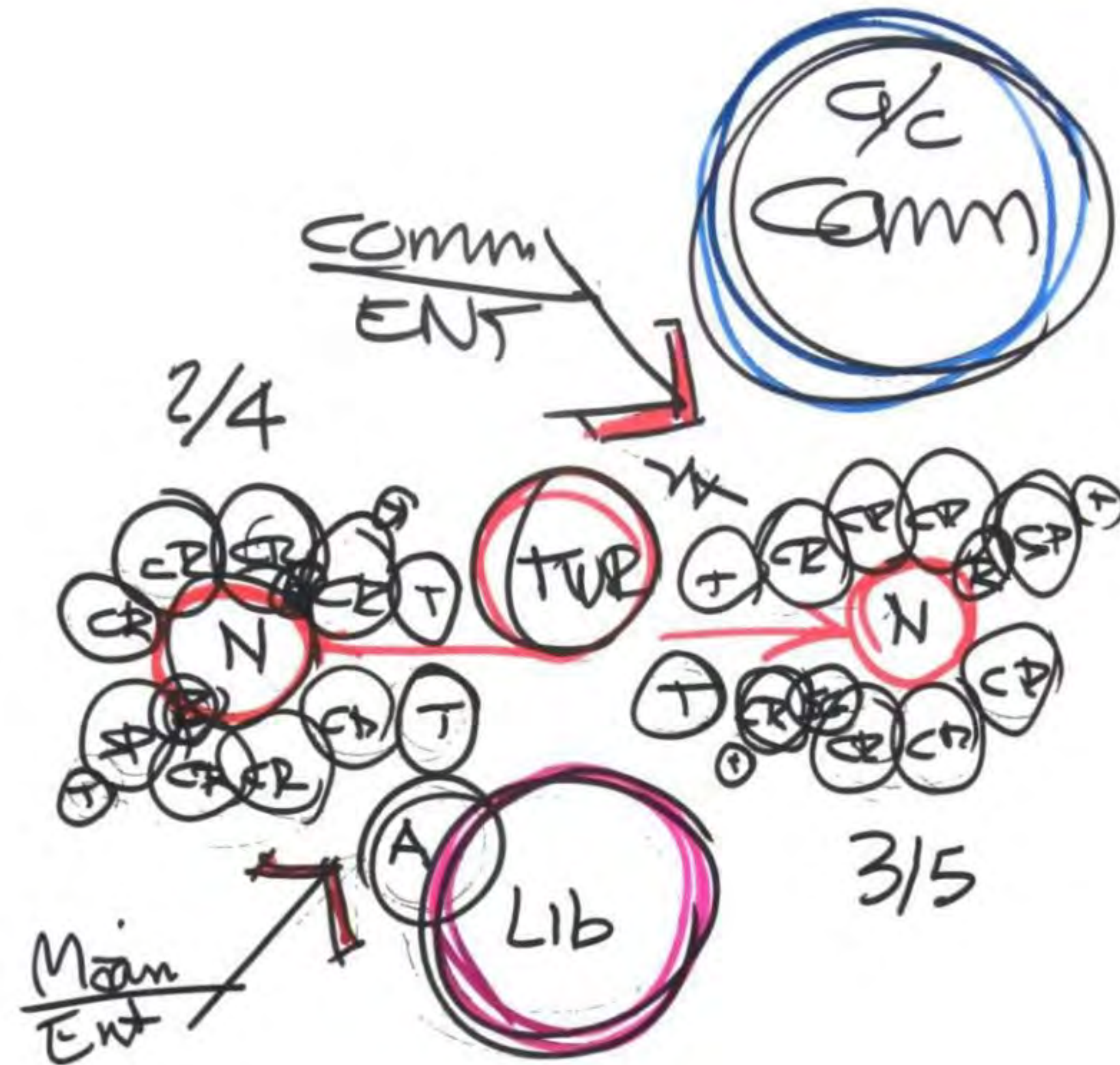



# Talking Points

*What do we need to communicate to the Wakefield community about our priorities for the renovated and/or new Wakefield High School facility and campus?*

- Level of Community Need
- Connections to School Agenda
- Connections to Forward-Thinking Planning
- Educational Needs
- Architectural Priorities





**Wakefield** Memorial  
High School

Q & A